

Denali Light Mount

BMW F800GS '13-'14

BMW F800GS Adventure '14-

LAH.07.10100 Instructions Rev:00

PLEASE READ BEFORE INSTALLING

TWISTED THROTTLE products should be installed by a qualified, experienced motorcycle technician. If you are unsure of your ability to properly install a product, please have the product installed by your local motorcycle dealer. TWISTED THROTTLE takes no responsibility for damages caused by improper installation.

All screws, bolts, and nuts, including all replacement hardware provided by TWISTED THROTTLE should be tightened to the torque specified in the OEM maintenance manual for your motorcycle. If no torque specifications are provided in the OEM maintenance manual, the following torques may be used:

M5.....	3.5 ft-lbs (5 Nm)
M6.....	7 ft-lbs (9.6 Nm)
M8.....	13 ft-lbs (18 Nm)

All screws, bolts, and nuts should be checked after driving the first 30 miles (50 km) to ensure that all are tightened to the proper torque.

Medium strength liquid thread-locker (i.e., "Locktite") should be used to secure all screws, bolts, and nuts.

Distributed by:	
Twisted Throttle LLC 570 Noose Neck Rd Exeter, RI 02822	phone: 401.284.4200 fax: 401.223.6955 www.twistedthrottle.com



Installation Instructions

Step 1

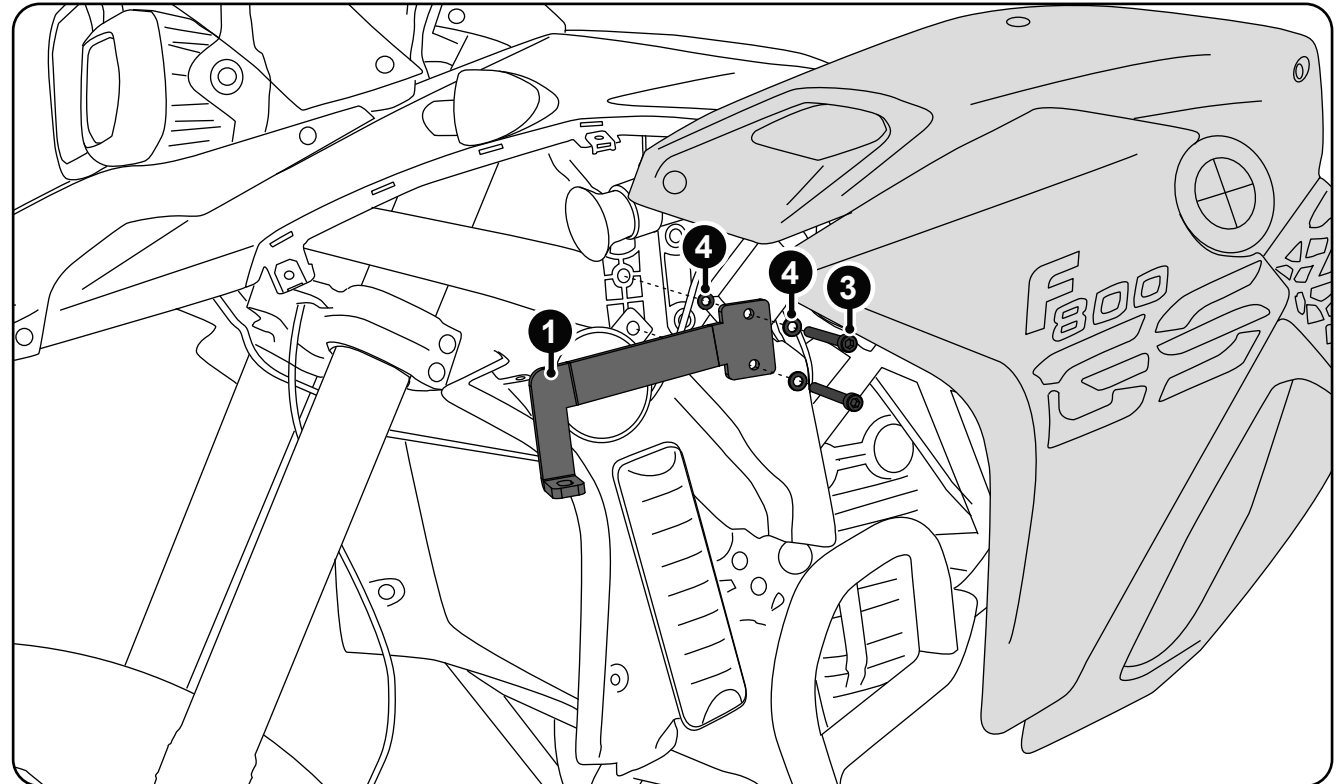
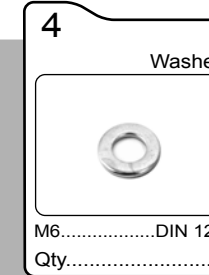

Step One: Remove the left and right side fairings from your bike to expose the fairing stay mounting points on each side.

Step Two: Starting on the left side of the motorcycle, remove the two original bolts from the mounting location shown above. Use the extra washer on the backside of the bracket to level it out with the horn bracket. Tighten the bolts and torque to specs, then reinstall the left side fairing.

Step Three: Remove the two original bolts from the right side of the bike and mount the bracket using the supplied hardware. Tighten the bolts and torque to spec, then reinstall the right side fairing.